

KWKSd215H100 Internal Bend 2 Comp.

Overview:

Application

Indoor cable routing for power, voice, and data services

Material

Electro-galvanised steel (EGS) to PN-EN 10152 Paint-finished - white to RAL9010 or grey to RAL 7035

Available to order:

L - powder coating in a full range of colours (PC)

Note: Cover included

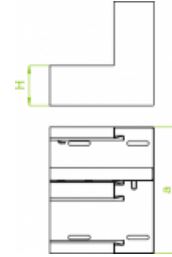
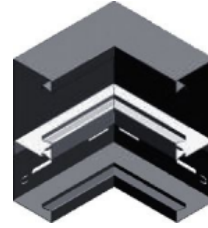

Connected products:



KPKS...H100 90° Elbow



KPKSd215H100 90° Elbow 2 Comp.



KS...H100 Wall Trunking



KSd215H100 Wall Trunking 2 Comp.



KWKS...H100 Internal Bend



KZKS...H100 External Bend



KZKSd215H100 External Bend 2 Comp.



TSKS...H100 Tee



TSKSd215H100 Tee 2 Comp.



ZK...H100 Blind End



LKSH100 Notched Connector