

## LDSUC Add-on Connector

### Overview:

**Application**

Branching out from any area of already existing cable runs.  
Protection against cable slipping from the run while pulling and using.

**Material**

Steel, strip-galv. acc. to the Sendzimir method to PN-EN 10346:2011 (SG)

**Available to order:**

**F-** steel, hot-dip galv. to PN-EN ISO 1461:2011 (HDG)

**E-** stainless steel (SS)

**L-** powder coating in a full range of colours (PC)

**Quick and firm installation to any area of cable tray: no hole drilling necessary!**

**Important! The Add-on Connector should be adjusted to the tray side heights:**

- LDSUC1 will suit long span cable trays and ladders H100
- LDSUC2 will suit long span cable trays and ladders H110
- LDSUC3 will suit long span cable trays and ladders H120, H150, and H200.

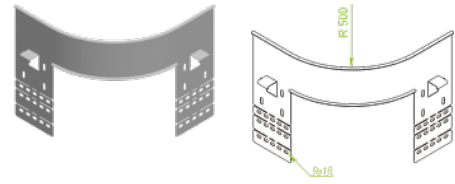

### Versions:

Sheet thickness: **2,0 mm**

Symbol	Catalogue number	Quantity in box	Weight 1 pc.
LDSUC1	205001	2	1,19
LDSUC2	205002	2	1,26
LDSUC3	205003	2	1,87