

## UCW... Beam Clamp

### Overview:

**Application**

Suspending cable routes

**Material**

Steel, hot-dip galv. to PN-EN ISO 1461:2011 (HDG)

**Available to order:**

E- stainless steel (SS)

L- powder coating in a full range of colours (PC)

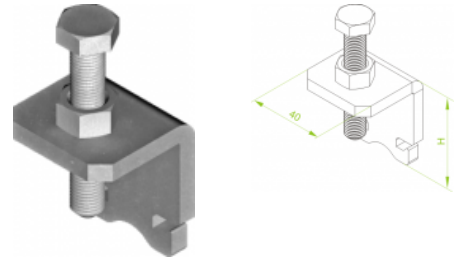

### Versions:

Symbol	Sheet thickness [mm]	Catalogue number	Quantity in box	Height H [mm]	Weight 1 pc.	Maximum load Fmax[kN]
UCW1	6	752408	30	46	0,18	2,00
UCW2	8	752409	30	50	0,22	2,50