

## UD... Hold Down Clamp

### Overview:

**Application**  
Suspending cable routes

**Material**  
Steel, hot-dip galv. to PN-EN ISO 1461:2011 (HDG)

**Available to order:**  
E- stainless steel (SS)  
L- powder coating in a full range of colours (PC)

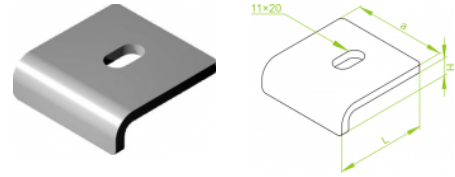

### Versions:

Symbol	Length L [m]	Width a [mm]	Sheet thickness [mm]	Catalogue number	Quantity in box	Height H [mm]	Weight 1 pc.	Maximum load Fmax[kN]
UD	60	30	5	750706	100	12	0,07	1,80
UD1	60	60	5	751206	50	12	0,15	4,00
UD2	60	60	5	751306	50	20	0,20	4,00
UD3	70	60	8	751406	30	20	0,32	6,00
UD4	70	80	8	751606	25	28	0,42	6,50