

ZSP1... Beam Clip

Overview:

APPLICATION

Suspending lightweight assemblies from strut open sections

Material

Electro-galvanised (electroplated) spring steel

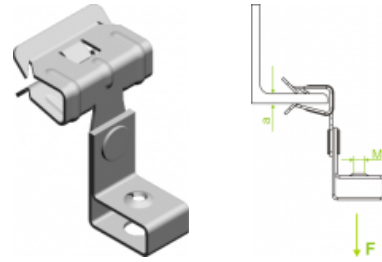

Versions:

Sheet thickness: **1,0 mm**

Symbol	Catalogue number	Quantity in box	Maximum load Fmax[kN]	Size M [mm]	Thickness a
ZSP1M6/2	790101	100	0,70	6	2-3
ZSP1M6/3	790201	100	0,90	6	3-8
ZSP1M6/8	790301	100	0,90	6	8-14
ZSP1M6/14	790401	100	0,90	6	14-20
ZSP1M8/2	790501	100	0,70	8	2-3
ZSP1M8/3	790601	100	0,90	8	3-8
ZSP1M8/8	790701	100	0,90	8	8-14
ZSP1M8/14	790801	100	0,90	8	14-20
ZSP1M10/2	790901	100	0,70	10	2-3
ZSP1M10/3	791001	100	0,90	10	3-8
ZSP1M10/8	791101	100	0,90	10	8-14
ZSP1M10/14	791201	100	0,90	10	14-20

Connected products:

