

PMO3E Junction Box

Overview:

APPLICATION

Connection and junction box, $U_i=400\text{ V}$, electrical functional integrity E30 / E60 / E90 acc to DIN 4102 part 12. Protection class IP65, sealing from 7mm to 28mm. Assembly through mounting holes to the concrete by Bolt Anchors SROM6x30. Assembly to cable ladders and cable trays by Screw sets SGKM6x12 and on the wire meshcable tray by UP2 or UPP... Mounting Plates by Screw sets SGNM6x12.



Podkladová doska možno aj s podstavkami v prílohách technických

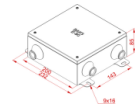

MATERIAL

PMO3 - steel, hot-dip galvanised to PN-EN ISO 1461:2011, powder coated to RAL 2003
 PMO3E - stainless steel 1.4301 powder coated to RAL 2003
 - Terminal made from special high-temperature resistant ceramics,
 - Cable gland made from halogen-free material
 - Fixing through integrated steel grips

Connected products:



UPU Mounting Plate



UPPO... Mounting Plate



UP1 Držiak inštalačnej škatule



UP2 Držiak inštalačnej škatule



UPP... Držiak škatule



SRO Kotva



MKR Skrutka rozťiažna



PSRO... Anchor Bolt



KKG5 Anchor Bolt



KSKO... Hollow - Ceiling Anchor



GSO... Ceiling Nail



SGK... Screw Set