

WSKL75 Hanger

Overview:

APPLICATIONS

Suspending luminaire cable trays
Assembly of cable tray 75 and 120mm wide

MATERIAL

Electro-galvanised steel (EG)
Available finishes:
F - steel, hot-dip galv. to
PN-EN ISO 1461:2011 (HDG)
E - stainless steel (SS), grade 1.4301 (AISI304)
L - powder painting in standard RAL color

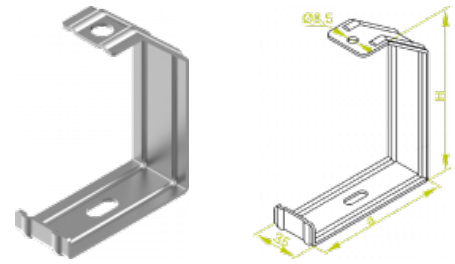

Features & Benefits:

Fast installation both directly to the ceiling, and with the use of a threaded rod.