

## NLM Rod Connector

### Overview:

**APPLICATIONS**

Suspending cable runs.

**MATERIAL**

Electro-galvanised steel (EG)

Available finishes:

E- Stainless steel, grade 1.4401 (A4)

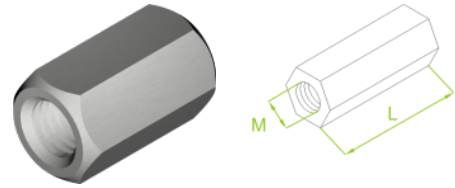

### Versions:

Symbol	Length L [m]	Catalogue number	Quantity in box	Thread M [mm]
<b>NLM8</b>	<b>24</b>	<b>650203</b>	<b>100</b>	<b>8</b>
<b>NLM10</b>	<b>30</b>	<b>650303</b>	<b>100</b>	<b>10</b>