

PW Washer

Overview:

APPLICATIONS

Supporting cable trays.

MATERIAL

Electro-galvanised steel (EG)

Available finishes:

E- Stainless steel, grade 1.4301 (A2) or 1.4401 (A4)

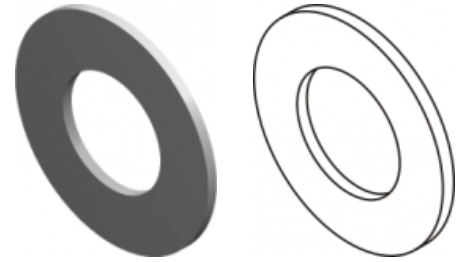

Versions:

Symbol	Catalogue number	Quantity in box	Apply to:
PW8	650944	100	M8
PW10	651044	100	M10