

LZZMP...H100 45° Vertical Bend - External

Overview:

APPLICATION

Diversion in cable routing

Material

Hot-dip galv. steel to PN-EN ISO 1461:2011 (HDG)

Available to order:

E- stainless steel (SS)

L- powder coating in a full range of colours (PC)

For joining fittings to cable tray lengths use Straight Connectors LZC...

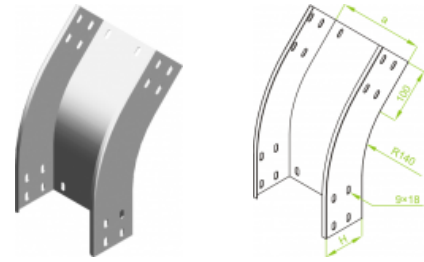

Versions:

Sheet thickness: **1,5 mm**

Symbol	Width a [mm]	Catalogue number	Quantity in box	Weight 1 pc.
LZZMP100H100	100	311610	6	1,19
LZZMP200H100	200	311620	6	1,54
LZZMP300H100	300	311630	4	1,89
LZZMP400H100	400	311640	4	2,24
LZZMP500H100	500	311650	2	2,60
LZZMP600H100	600	311660	2	2,95

Connected products:



KZP...H100
Cable Tray



KZLP...H100
Cable Tray with
Integral
Connector



KKZP...H100 90°
Horizontal Bend



KKZMP...H100
45° Horizontal
Bend



TKZP...H100
Horizontal Tee



CZKZP...H100
Horizontal
Cross-over



LZZP...H100 90°
Vertical Bend -
External



LZWP...H100
90° Vertical
Bend - Internal



LZWMP...H100
45° Vertical
Bend - Internal



TRZP...H100
Vertical Tee -
Lengthwise



RKZP...H100
Straight
Reducer