

LZZMC...H100 45° Vertical Bend - External

Overview:

APPLICATION

Diversion in cable routing

Material

Hot-dip galv. steel to PN-EN ISO 1461:2011 (HDG)

Available to order:

E- stainless steel (SS)

L- powder coating in a full range of colours (PC)

For joining fittings to cable tray lengths use Straight Connectors LZC...

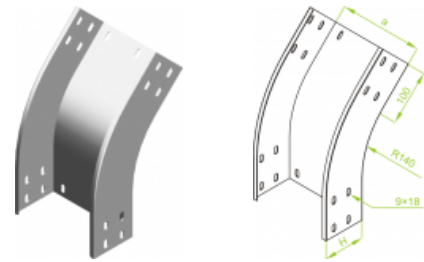

Versions:

Sheet thickness: **2,0 mm**

Symbol	Width a [mm]	Catalogue number	Quantity in box	Weight 1 pc.
LZZMC100H100	100	311710	6	1,58
LZZMC200H100	200	311720	6	2,10
LZZMC300H100	300	311730	4	2,52
LZZMC400H100	400	311740	4	2,93
LZZMC500H100	500	311750	2	3,47
LZZMC600H100	600	311760	2	3,93

Connected products:

