

## LZWMC...H200 45° Vertical Bend - Internal

### Overview:

**APPLICATION**

Diversion in cable routing

**Material**

Hot-dip galv. steel to PN-EN ISO 1461:2011 (HDG)

**Available to order:**

E- stainless steel (SS)

L- powder coating in a full range of colours (PC)

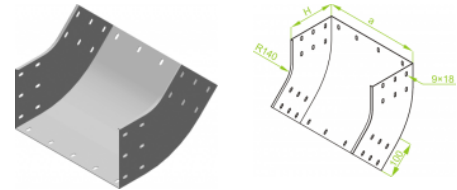

**For joining fittings to cable tray lengths use Straight Connectors LZC...**

### Versions:

Sheet thickness: **2,0 mm**

Symbol	Width a [mm]	Catalogue number	Quantity in box	Weight 1 pc.
LZWMC200H200	200	372120	2	3,00
LZWMC300H200	300	372130	2	3,47
LZWMC400H200	400	372140	1	3,95
LZWMC500H200	500	372150	1	4,42
LZWMC600H200	600	372160	1	4,88

### Connected products:



KZC...H200  
Cable Tray



KZLC...H200  
Cable Tray with  
Integral  
Connector



LZCH200  
Straight  
Connector



LCC...H200  
U-Shaped  
Connector



LZGCH200  
Articulated  
Connector



KKZC...H200 90°  
Horizontal Bend



KKZMC...H200  
45° Horizontal  
Bend



TKZC...H200  
Horizontal Tee



CZKZC...H200  
Horizontal  
Cross-over



LZVC...H200 90°  
Vertical Bend -  
External

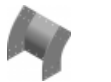

LZVMC...H200  
45° Vertical  
Bend - External

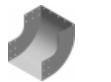

LZWC...H200  
90° Vertical  
Bend - Internal



TRZC...H200  
Vertical Tee -  
Lengthwise



RKZC...H200  
Straight  
Reducer